

# ME6 MOUNT-STYLE "P"-FEMALE ROD END

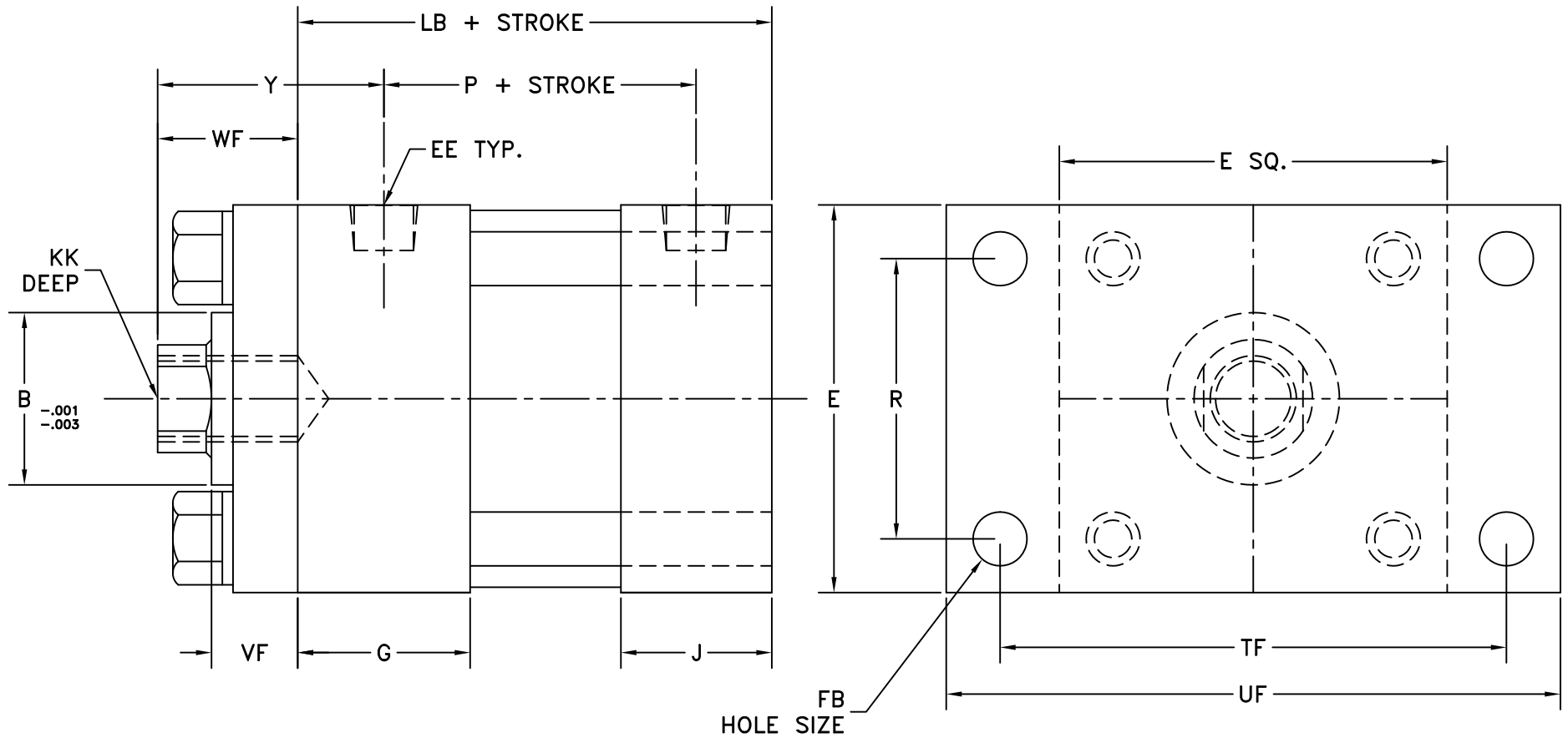

OPEN TOLERANCE NOTES:  
 FRACTIONAL DIMS.  $\pm 1/32$   
 2 PLACE DECIMALS  $\pm .010$   
 3 PLACE DECIMALS  $\pm .005$   
 ANGLES  $\pm 30$  MINUTES  
 UNLESS SPECIFIED

BREAK SHARP EDGES  
 REMOVE ALL BURRS  
 .015 R ALL CORNERS  
 UNLESS NOTED.

**YATES**  
 PHONE: (586) 778-7680  
 FAX: (586) 778-6565

THIS PRINT IS THE PROPERTY OF YATES IND. INC. AND IS LOANED SUBJECT TO RETURN UPON DEMAND. ITS CONTENTS ARE CONFIDENTIAL AND MUST NOT BE COPIED OR SUBMITTED TO OUTSIDE PARTIES FOR USE OR EXAMINATION. ALL RIGHTS TO DESIGN OR INVENTION ARE RESERVED BY YATES IND. INC.

SIZE C		APPV'D.		DWG NO.	REV
		DB 7-24-98		ME6RPF	
SCALE NTS		FF 7-24-98		SHEET	

# ME6 MOUNT-STYLE "P"-MALE ROD END

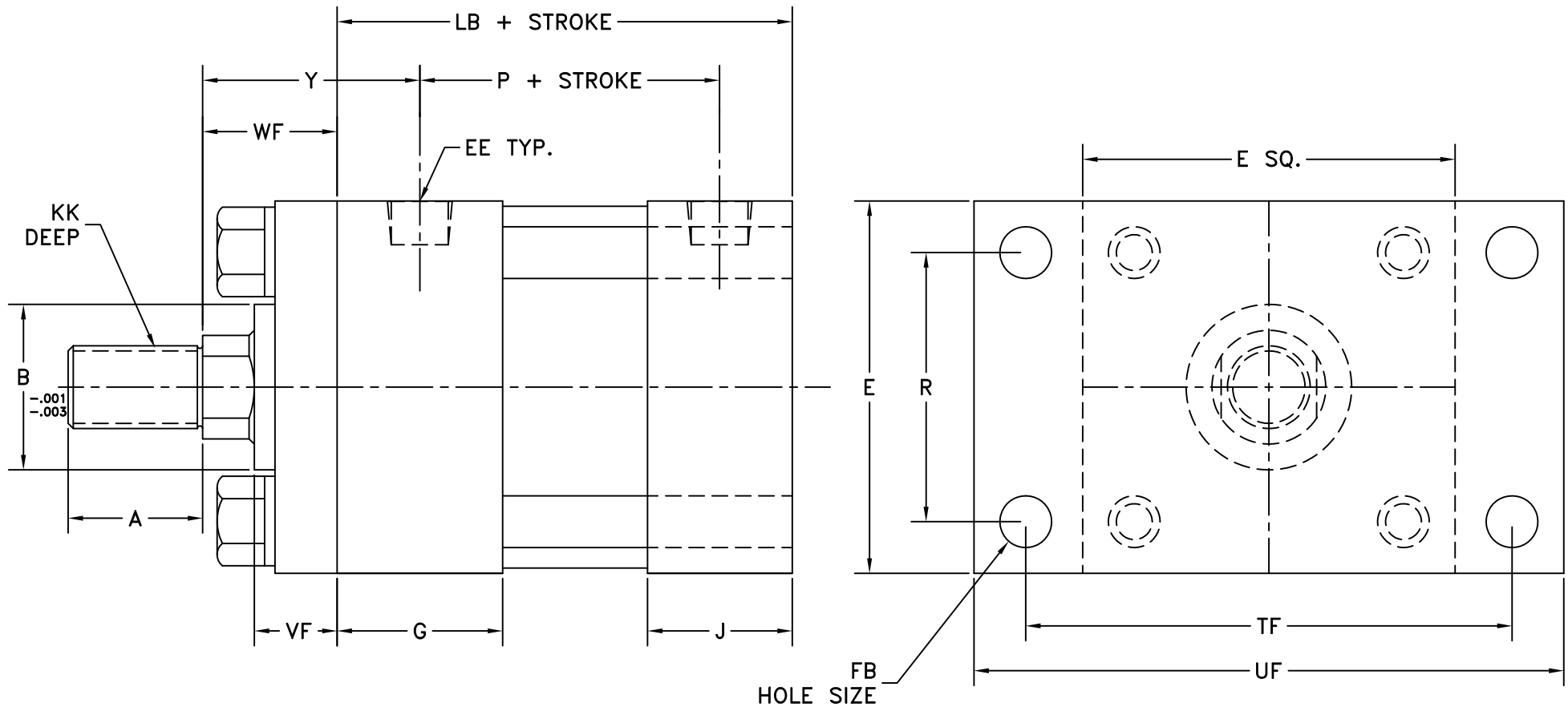

OPEN TOLERANCE NOTES:  
 FRACTIONAL DIMS.  $\pm 1/32$   
 2 PLACE DECIMALS  $\pm .010$   
 3 PLACE DECIMALS  $\pm .005$   
 ANGLES  $\pm 30$  MINUTES  
 UNLESS SPECIFIED

BREAK SHARP EDGES  
 REMOVE ALL BURRS  
 .015 R ALL CORNERS  
 UNLESS NOTED.



PHONE: (586) 778-7880  
 FAX: (586) 778-8565

THIS PRINT IS THE PROPERTY OF YATES IND. INC. AND IS LOANED SUBJECT TO RETURN UPON DEMAND. ITS CONTENTS ARE CONFIDENTIAL AND MUST NOT BE COPIED OR SUBMITTED TO OUTSIDE PARTIES FOR USE OR EXAMINATION. ALL RIGHTS TO DESIGN OR INVENTION ARE RESERVED BY YATES IND. INC.

ME6RPM

SIZE	APPV'D.	DWG NO.	REV
C	DB 7-25-98	ME6RPM	
SCALE	NTS	FF 7-25-98	SHEET