

ME5 MOUNT-STYLE "G"-FEMALE ROD END

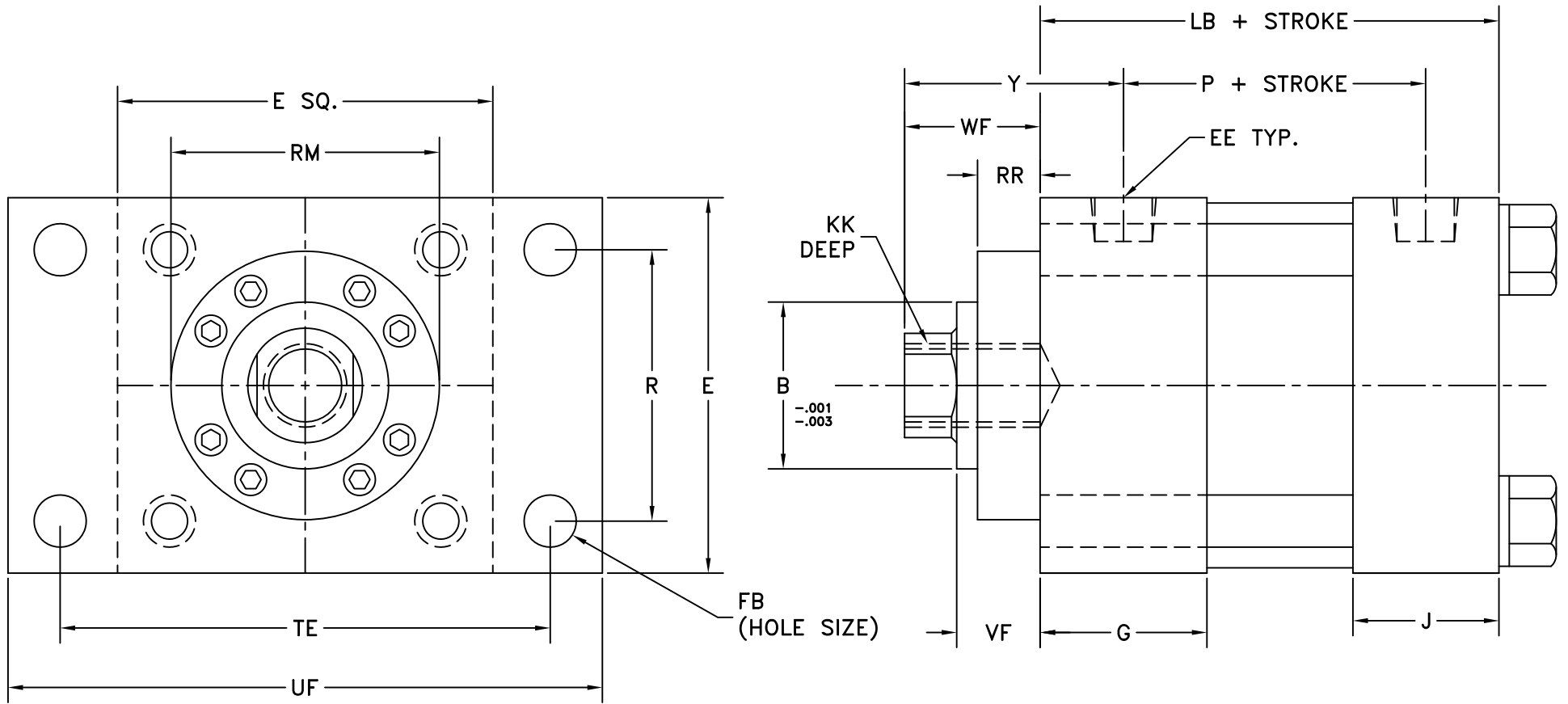

OPEN TOLERANCE NOTES:
 FRACTIONAL DIMS. $\pm 1/32$
 2 PLACE DECIMALS ± 0.010
 3 PLACE DECIMALS ± 0.005
 ANGLES ± 30 MINUTES
 UNLESS SPECIFIED

BREAK SHARP EDGES
 REMOVE ALL BURRS
 .015 R ALL CORNERS
 UNLESS NOTED.

YATES
 PHONE: (586) 778-7880
 FAX: (586) 778-6585

THIS PRINT IS THE PROPERTY OF YATES IND. INC. AND IS LOANED SUBJECT TO RETURN UPON DEMAND. ITS CONTENTS ARE CONFIDENTIAL AND MUST NOT BE COPIED OR SUBMITTED TO OUTSIDE PARTIES FOR USE OR EXAMINATION. ALL RIGHTS TO DESIGN OR INVENTION ARE RESERVED BY YATES IND. INC.

ME5RRF			
SIZE C	APP'VD DB 7-24-98	DWG NO. ME5RRF	REV
SCALE NTS	JH 7-24-98	SHEET	

ME5 MOUNT-STYLE "G"-MALE ROD END

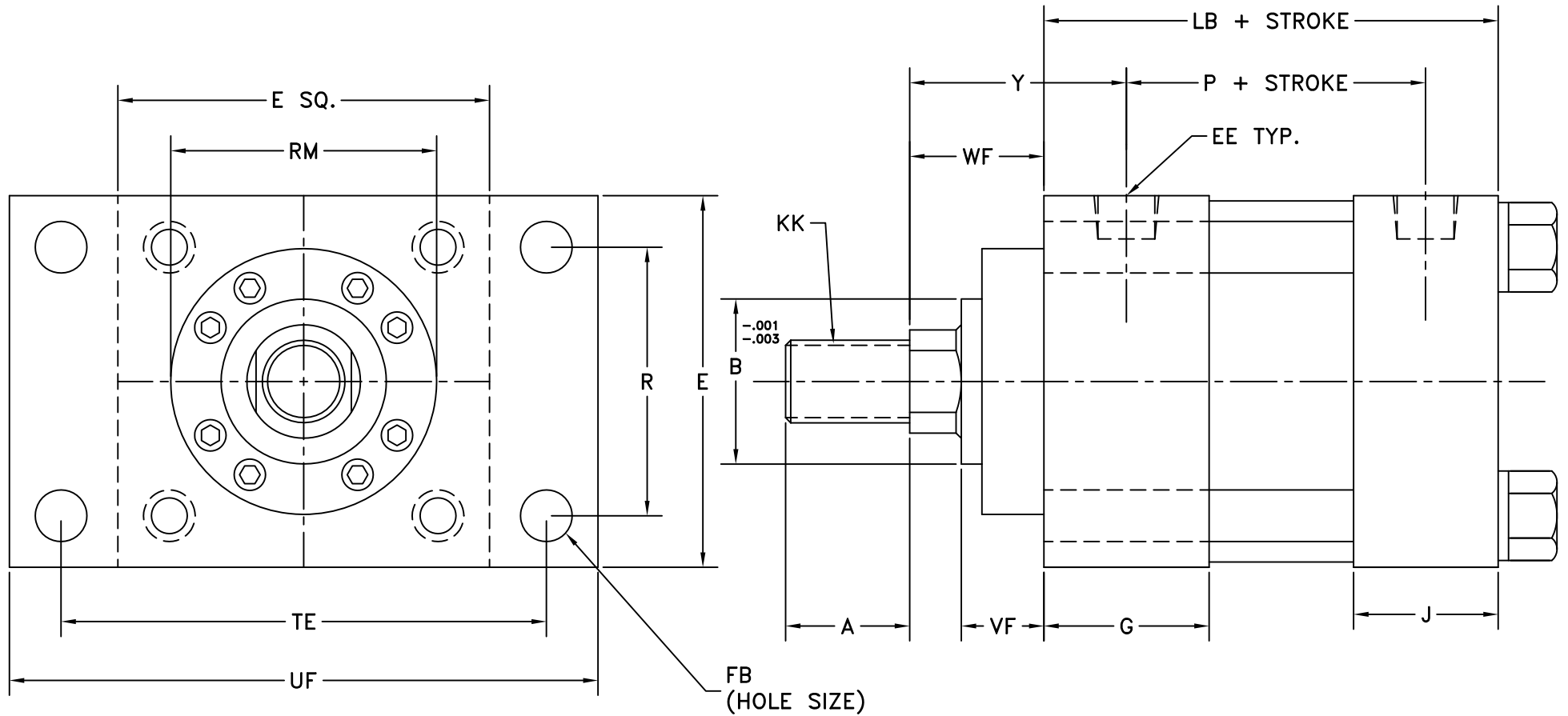

OPEN TOLERANCE NOTES:
 FRACTIONAL DIMS. $\pm 1/32$
 2 PLACE DECIMALS $\pm .010$
 3 PLACE DECIMALS $\pm .005$
 ANGLES ± 30 MINUTES
 UNLESS SPECIFIED

BREAK SHARP EDGES
 REMOVE ALL BURRS
 .015 R ALL CORNERS
 UNLESS NOTED.

YATES
 PHONE: (586) 778-7880
 FAX: (586) 778-8565

THIS PRINT IS THE PROPERTY OF YATES IND. INC. AND IS LOANED SUBJECT TO RETURN UPON DEMAND. ITS CONTENTS ARE CONFIDENTIAL AND MUST NOT BE COPIED OR SUBMITTED TO OUTSIDE PARTIES FOR USE OR EXAMINATION. ALL RIGHTS TO DESIGN OR INVENTION ARE RESERVED BY YATES IND. INC.

ME5RRM			
SIZE C	FSCM NO. DB 7-24-98	DWG NO. ME5RRM	REV
SCALE NTS	JH 7-24-98		SHEET